



I STREET WORKOUT OUTDOOR EQUIPMENT

**TURNKEY DELIVERIES DIRECTLY
FROM THE MANUFACTURER**
Bonita Group Service s.r.o.
www.playgrounds-bonita.com



Bonita
Playgrounds

Dear Customers,

We present the new catalogue of our company **Bonita Group Service s.r.o.**, where you will find a comprehensive range of workout elements and sets that are suitable additions to public spaces and contribute to the development of social life in the locations of their installation. More information and detailed descriptions of street workout elements and sets, ground plans, new products, special promotions, etc. can be found on our website at www.playgrounds-bonita.com.

Street workout elements and sets are part of the **ANTIVANDAL** programme. These elements and sets are manufactured from high-quality materials that guarantee maximum durability and the highest possible quality-to-price ratio.

All-metal workout elements and sets have minimal maintenance requirements, it is not necessary to re-paint them, and they are rigid, stable, colour-fast, and weather resistant. The most important advantage of these sets is their resistance to vandalism and long service life. The individual components are rigid, very hard to damage, and can withstand the maximum load without any risk of breaking or bending.



WHY GET A STREET WORKOUT PARK FROM US?

- Minimal maintenance requirements of our products.
- Versatility and variability.
- Street workout elements and sets are made from the finest materials and dimensioned to ensure maximum durability.
- We pay special attention to user safety even when designing the elements.
- High-quality workmanship.
- Installation is carried out by groups of professionally and technically trained personnel.
- Street workout elements and sets do not require a costly impact zone (pebble, rubber, cast rubber, etc.), and even a quality grass surface will suffice.
- Due to their all-metal structure, the elements and sets are nearly maintenance-free.

The main focus of our company is on reliability, timeliness, and the provision of high quality services. Our company reputation is based on honest and respectable interactions with our customers. Our concept is quality work at a professional level = a satisfied, returning customer.

We look forward to working with you and believe that you will be happy with our work.
The Bonita Group Service s.r.o. Team

All elements and sets meet all safety standards
Standard: ČSN EN 16630



GENERAL PRODUCT INFORMATION:

A street workout is a good opportunity for adults and youth alike who do not enjoy going to the gym and prefer to stay in the fresh air, because workout parks are usually located in public areas. This type of activity is widespread throughout the world, and the number of workout parks has also been growing in the Czech Republic in recent years, thus becoming not only a trend but also part of everyday life. Street workouts are bodyweight exercises that contribute to improving physical fitness, strength, and endurance. However, they are not just about the workout itself, but also about humbleness, morality, healthy lifestyle, and establishing friendships. They are based on various exercises using parallel bars, cross bars, wall bars, and other structures. A street workout combines sports and entertainment and helps keep the youth away from drugs, alcohol, and other negative influences, which undoubtedly has a positive impact on society. We offer a wide range of workout elements and sets made from structural steel. These workout elements and sets have minimal maintenance requirements and are rigid, stable, and weather resistant. The most important advantage of these elements and sets is their long service life and resistance to vandalism. Our comprehensive range offers six colour variants for the structures (blue, green, red, yellow, grey, orange) and two variants of handles (black, stainless steel). You can choose between a complete park and individual elements and sets that can be used to build a park to your liking.



MATERIALS AND SURFACE TREATMENT OF SUPPORTING STRUCTURES

The support structure of the workout elements and sets is made of structural steel (metal profile 100 × 100 × 4 mm) which is protected against corrosion by a zinc coating, resulting in a very prolonged service life for the workout elements, as the coating is done with KOMAXIT baked paint according to the RAL colour system. These structures are anchored to concrete footings. All other metallic elements, such as handles, parallel bars, etc., are also zinc coated and treated with KOMAXIT baked paint according to the RAL colour system or, if required by the customer, the elements can be made from stainless steel.

All bench boards and steps are made of high quality HDPE (high-pressure, full-coloured polyethylene, which is characterised by high colour stability, UV resistance, and high degree of safety because it is rigid and there is no risk of injury caused by sharp broken fragments). All connecting material is zinc or stainless steel coated.



DETERMINATION OF EQUIPMENT

- Our workout elements and sets are intended for users 15 years of age and older.
- All elements and sets are designed in accordance with the ČSN EN 16630 standard that sets out the conditions for outdoor fitness equipment for adults, which includes general safety, control, maintenance, and testing method requirements.
- All elements and sets are dimensioned with regard to a long service life and resistance to vandalism.

SUPPORT AND SERVICE

All elements and sets are manufactured directly at the company's premises, therefore the delivery of spare parts and the provision of warranty and post-warranty service are a matter of course.

Since we are constantly improving and upgrading our products, some visualisations or photos of elements and sets may not be identical to the real product at the given moment and may be slightly different. Similarly, the colour design of the products may be changed. Therefore, Bonita Group Service s.r.o. reserves the right to change both the technical design and the appearance of all the products in the catalogue.



STREET WORKOUT

WORKOUT ELEMENT

WP001

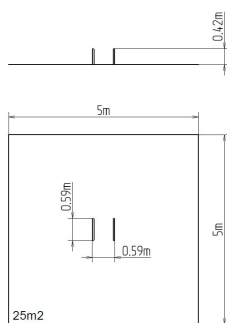

15+



1 m

COLOUR VARIANTS



IMPACT ZONE
GRASS

WORKOUT ELEMENT

WP002

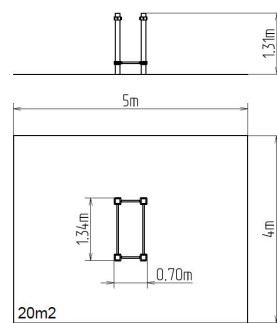
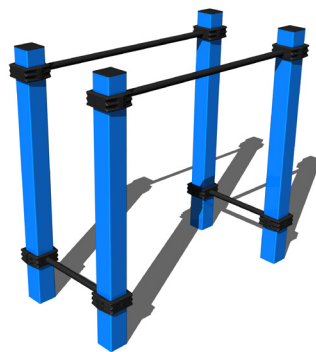

15+



1 m

COLOUR VARIANTS



IMPACT ZONE
GRASS

STREET WORKOUT

WORKOUT ELEMENT
WP003

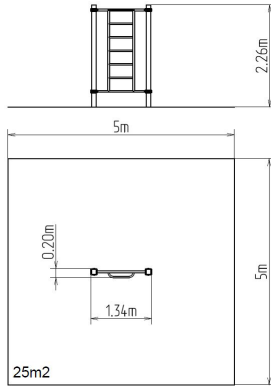
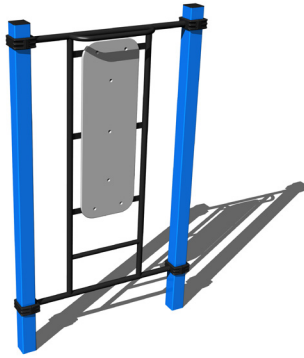

15+



1.5 m

COLOUR VARIANTS



IMPACT ZONE
GRASS

WORKOUT ELEMENT
WP004

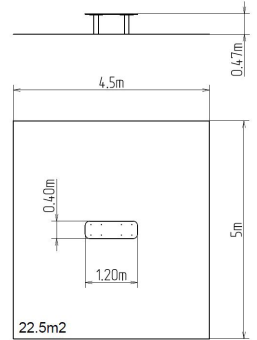
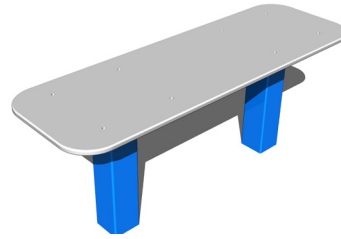

15+



1 m

COLOUR VARIANTS



IMPACT ZONE
GRASS

WORKOUT ELEMENT
WP005

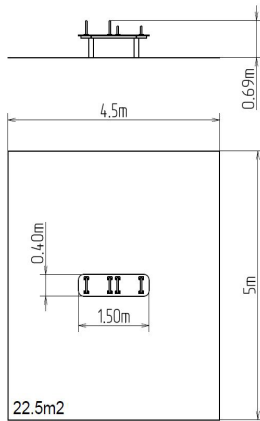
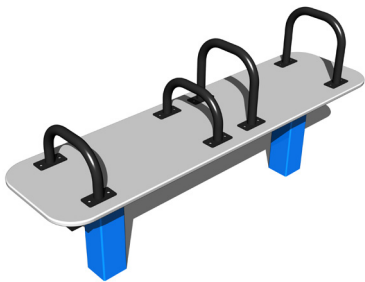

15+



1 m

COLOUR VARIANTS



IMPACT ZONE
GRASS

WORKOUT ELEMENT
WP006

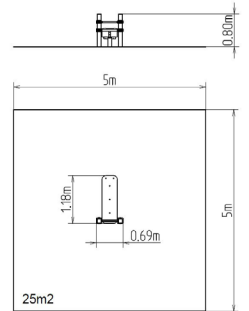
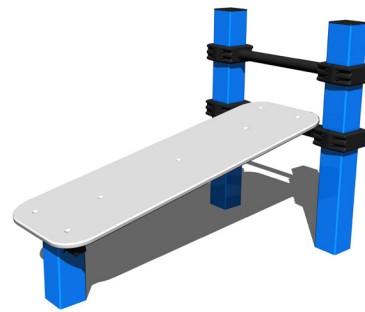

15+



1 m

COLOUR VARIANTS



IMPACT ZONE
GRASS

WORKOUT ELEMENT
WP007

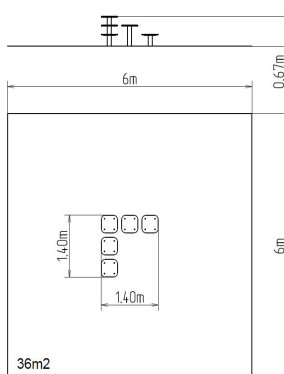
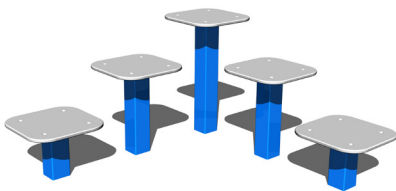

15+



1 m

COLOUR VARIANTS



IMPACT ZONE
GRASS

WORKOUT ELEMENT
WP008

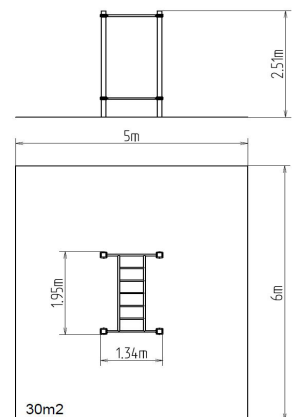
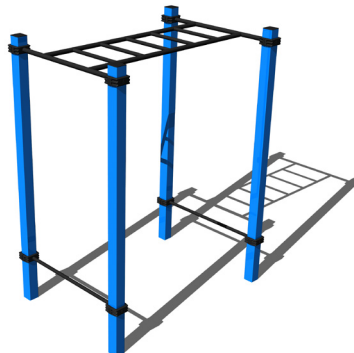

15+



1.5 m

COLOUR VARIANTS



IMPACT ZONE
GRASS

STREET WORKOUT

WORKOUT ELEMENT
WP009

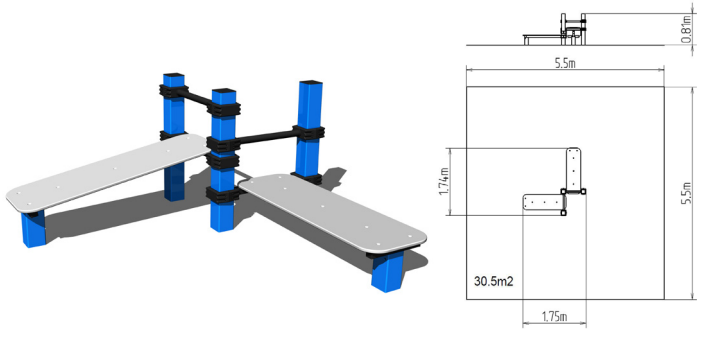

15+ ↓ 1 m

COLOUR VARIANTS

IMPACT ZONE GRASS

WORKOUT ELEMENT
WP010

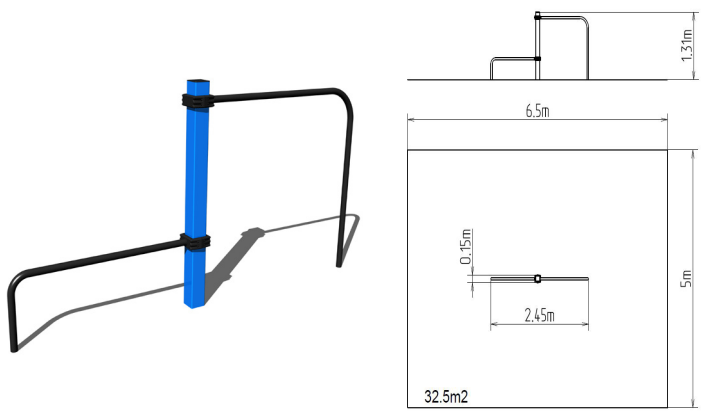

15+ ↓ 1 m

COLOUR VARIANTS

IMPACT ZONE GRASS

WORKOUT ELEMENT
WP011

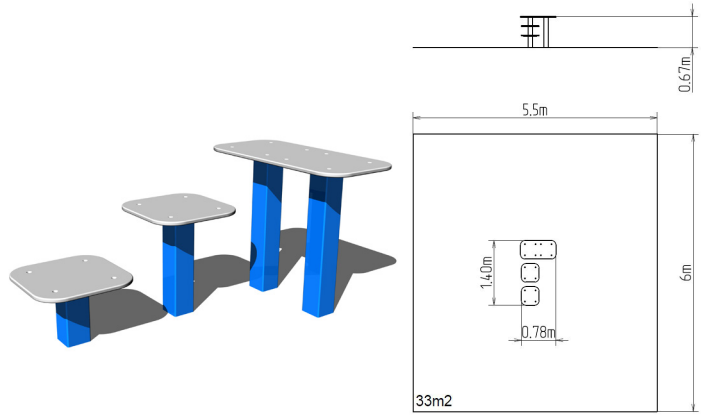

15+ ↓ 1 m

COLOUR VARIANTS

IMPACT ZONE GRASS

WORKOUT ELEMENT
WP012

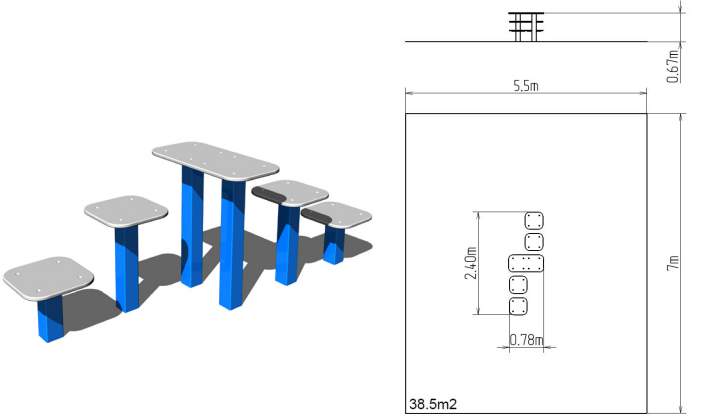

15+ ↓ 1 m

COLOUR VARIANTS

IMPACT ZONE GRASS

WORKOUT ELEMENT
WP013

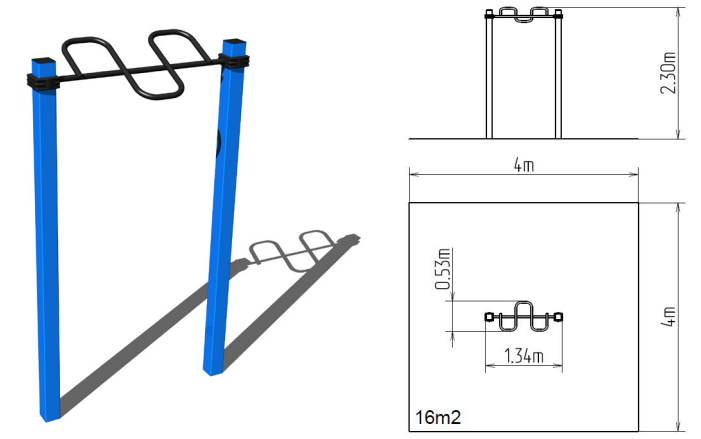

15+ ↓ 1.5 m

COLOUR VARIANTS

IMPACT ZONE GRASS

WORKOUT ELEMENT
WP014

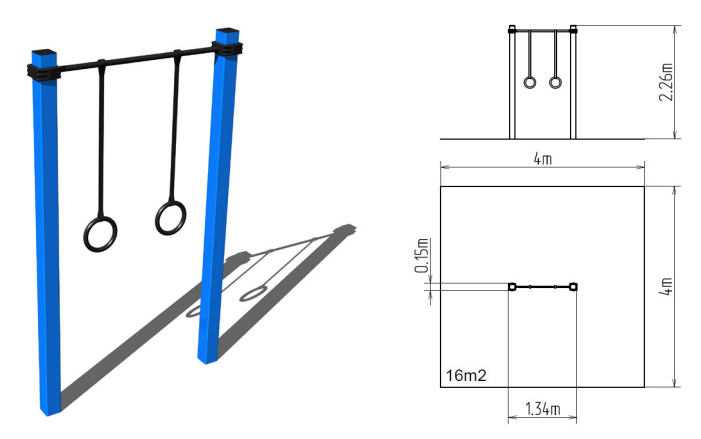

15+ ↓ 1.5 m

COLOUR VARIANTS

IMPACT ZONE GRASS

STREET WORKOUT

WORKOUT SET
WS001

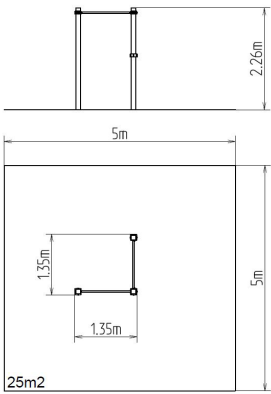
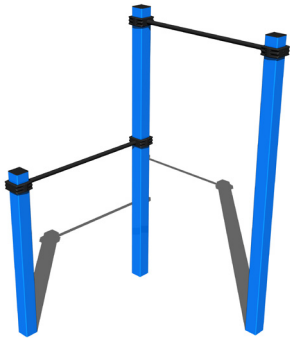

15+



1.5 m

COLOUR VARIANTS



WORKOUT SET
WS002

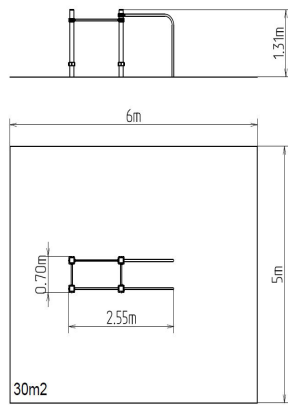
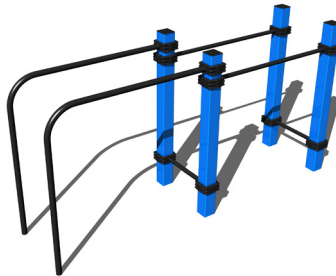

15+



1 m

COLOUR VARIANTS



WORKOUT SET
WS003

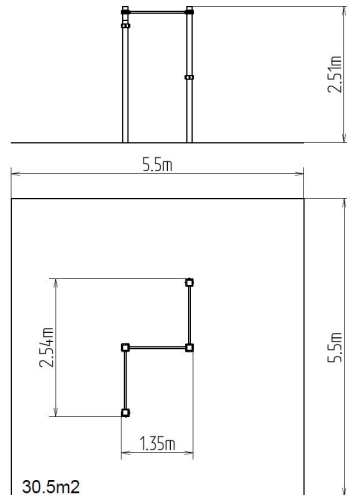
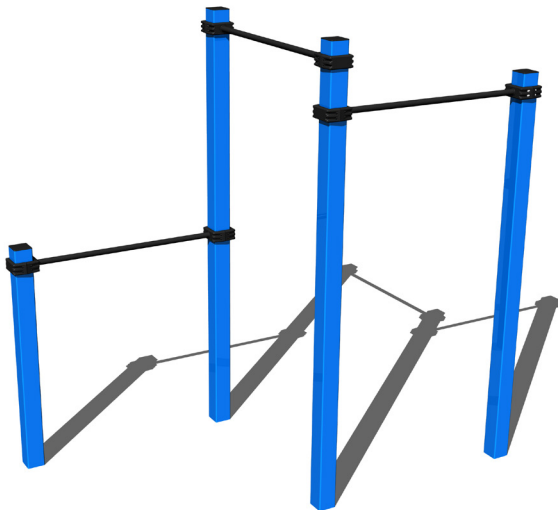

15+



1.5 m

COLOUR VARIANTS



STREET WORKOUT



STREET WORKOUT

WORKOUT SET
WS004

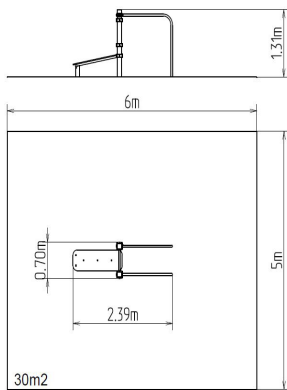
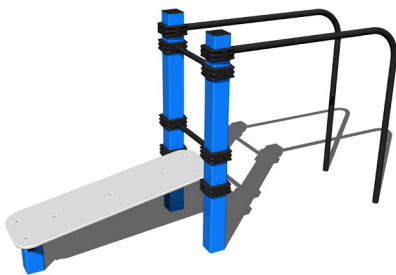

15+



1 m

COLOUR VARIANTS



IMPACT ZONE
GRASS

WORKOUT SET
WS005

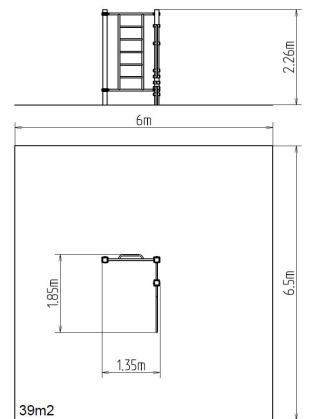
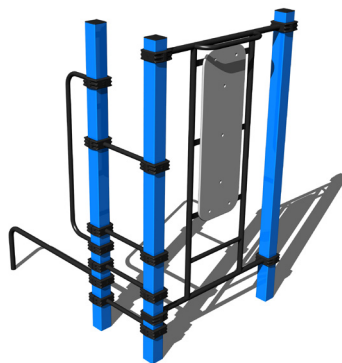

15+



1.5 m

COLOUR VARIANTS



IMPACT ZONE
GRASS

STREET WORKOUT

WORKOUT SET
WS006

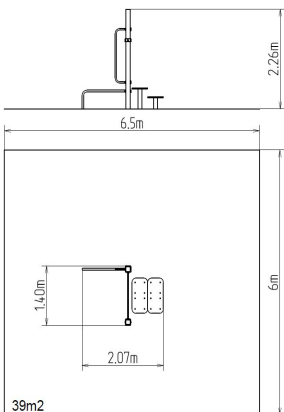
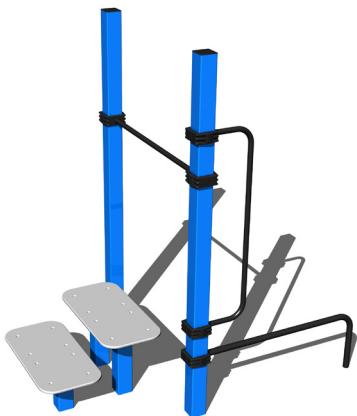

15+ ↓ 1 m

COLOUR VARIANTS



WORKOUT SET
WS007

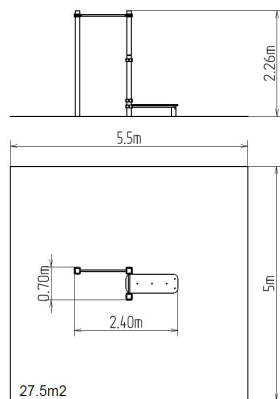
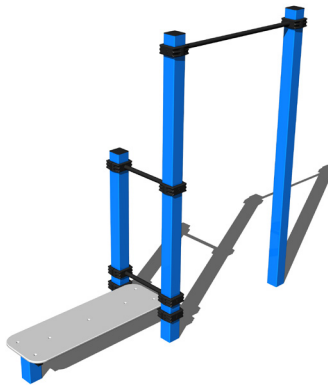

15+ ↓ 1.5 m

COLOUR VARIANTS



WORKOUT SET
WS008

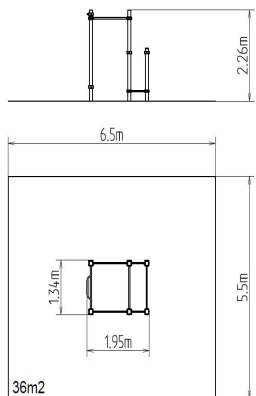

15+ ↓ 1.5 m

COLOUR VARIANTS



WORKOUT SET
WS010

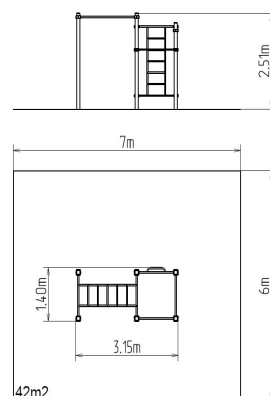
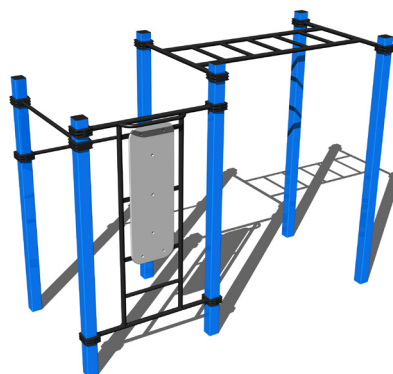

15+ ↓ 1.5 m

COLOUR VARIANTS



WORKOUT SET
WS011

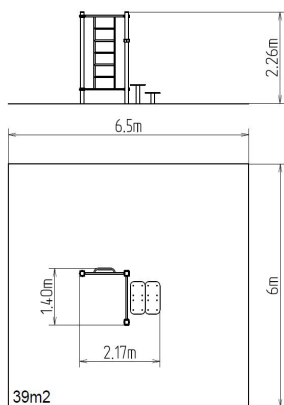
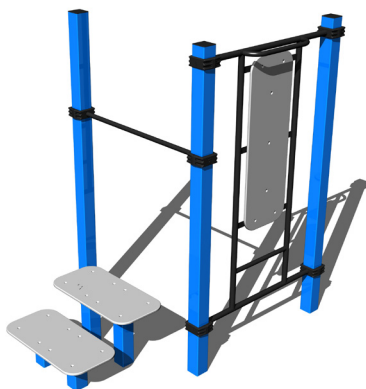

15+ ↓ 1.5 m

COLOUR VARIANTS



WORKOUT SET
WS012

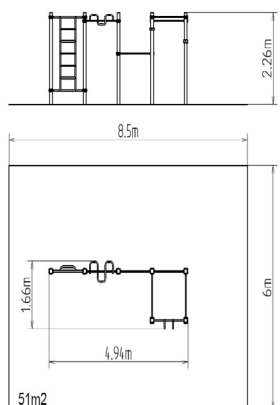
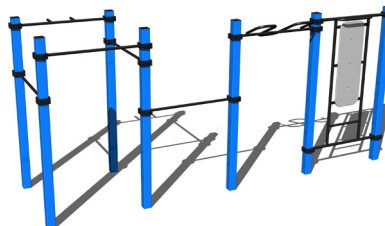

15+ ↓ 1.5 m

COLOUR VARIANTS



STREET WORKOUT

WORKOUT SET
WS013

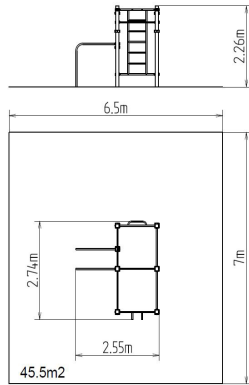
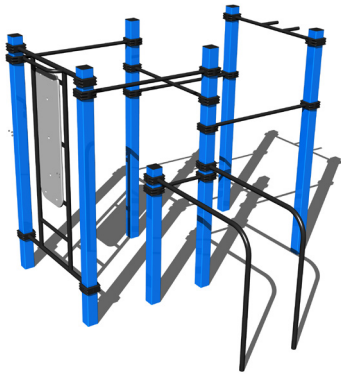

15+



COLOUR VARIANTS



IMPACT ZONE
GRASS

WORKOUT SET
WS014

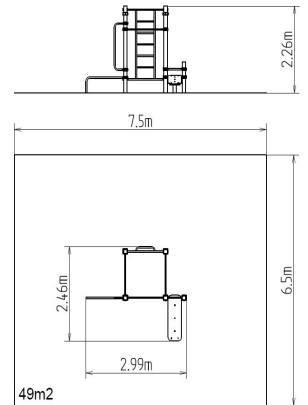
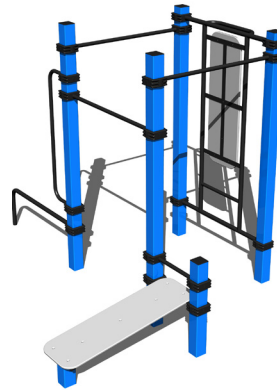

15+



COLOUR VARIANTS



IMPACT ZONE
GRASS

WORKOUT SET
WS015

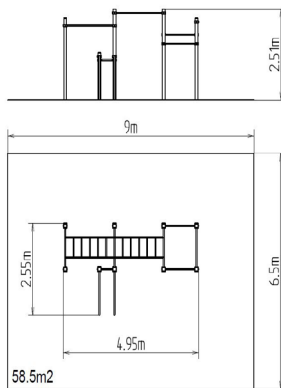
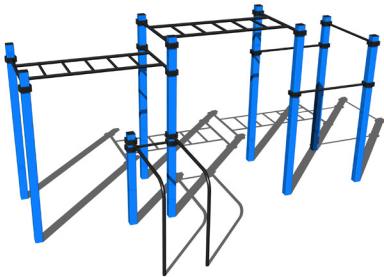

15+



COLOUR VARIANTS



IMPACT ZONE
GRASS

WORKOUT SET
WS016

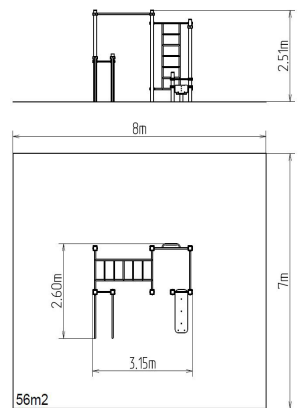
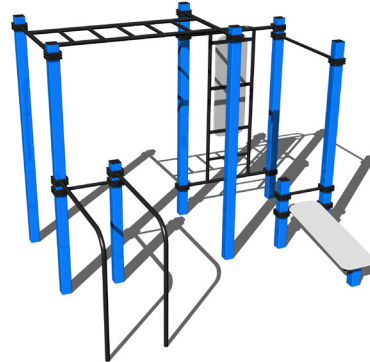

15+



COLOUR VARIANTS



IMPACT ZONE
GRASS

WORKOUT SET
WS017

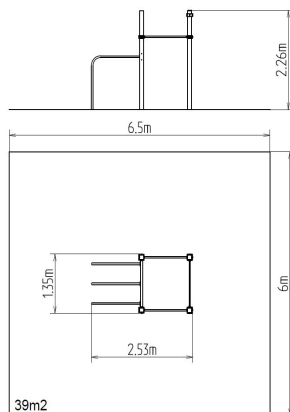
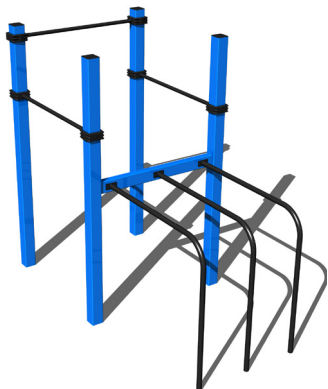

15+



COLOUR VARIANTS



IMPACT ZONE
GRASS

WORKOUT SET
WS018

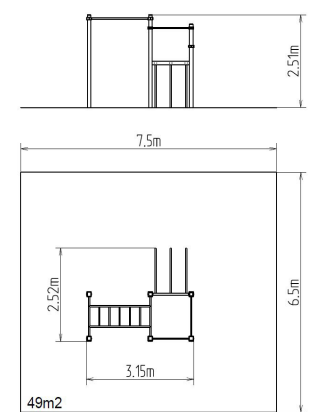
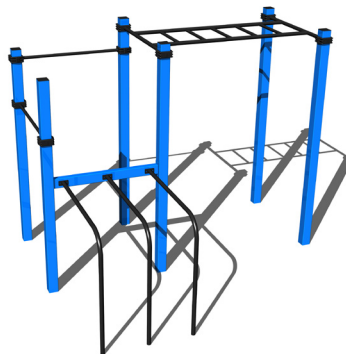

15+



COLOUR VARIANTS



IMPACT ZONE
GRASS

STREET WORKOUT

WORKOUT SET WS019

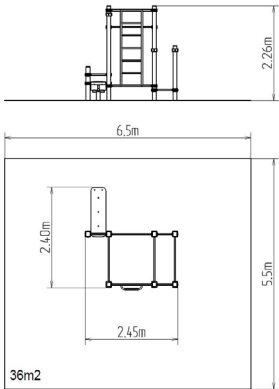
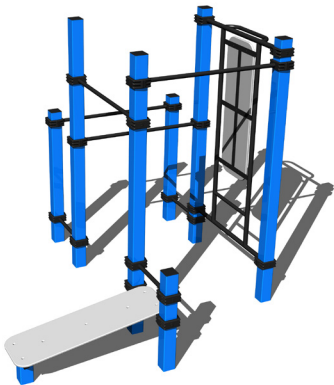

15+



1.5 m

COLOUR VARIANTS



WORKOUT SET WS020

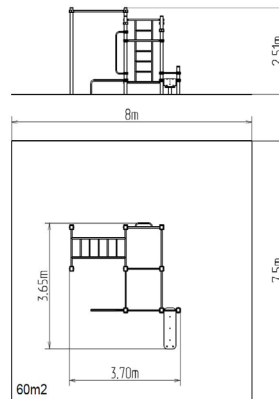
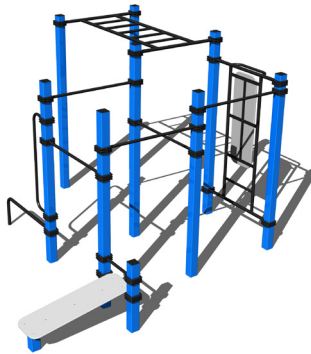

15+



1.5 m

COLOUR VARIANTS



STREET WORKOUT

STREET WORKOUT

WORKOUT SET
WS021

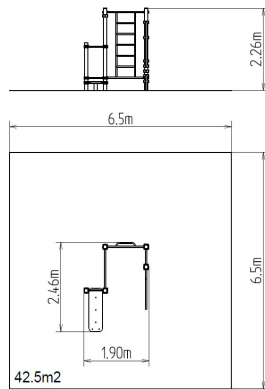
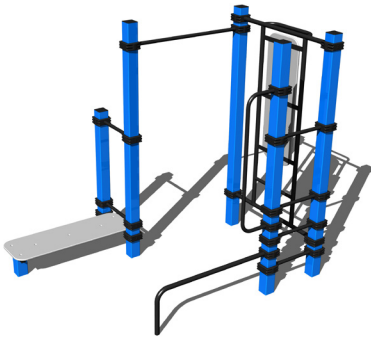

WORKOUT SET
WS024

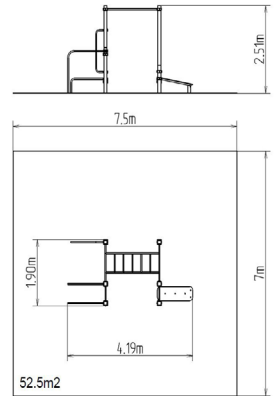
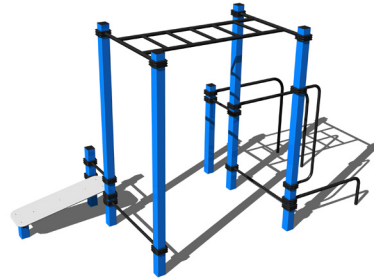

15+ ↓ 1.5 m

COLOUR VARIANTS



15+ ↓ 1.5 m

COLOUR VARIANTS



WORKOUT SET
WS022

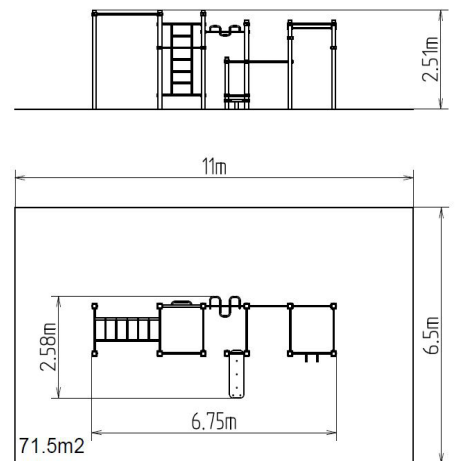
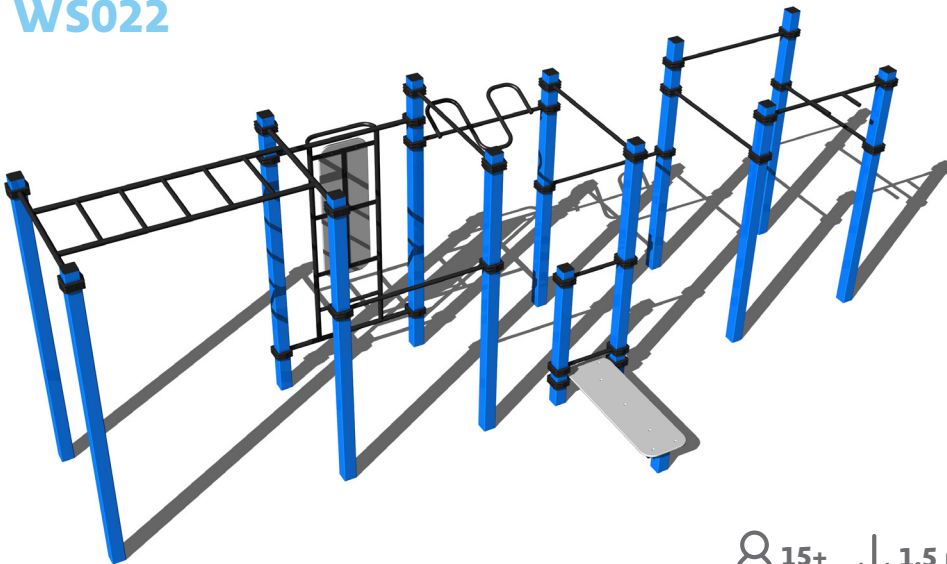

15+ ↓ 1.5 m

COLOUR VARIANTS



WORKOUT SET
WS023

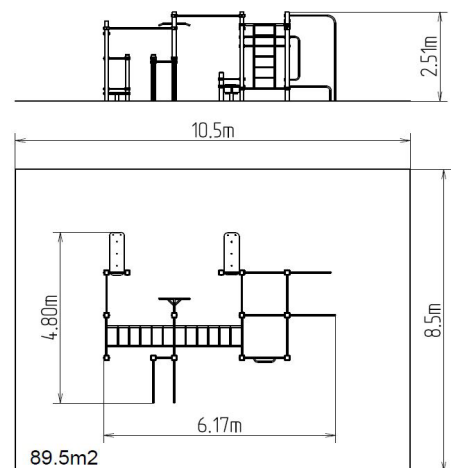
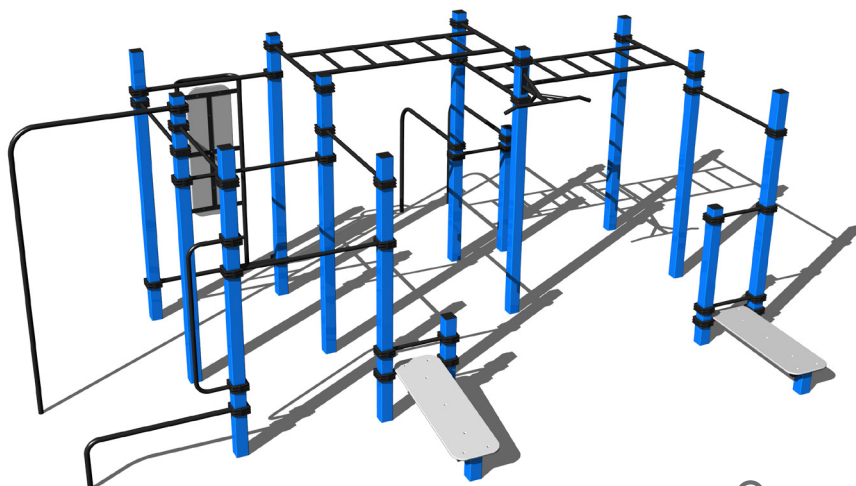

15+ ↓ 1.5 m

COLOUR VARIANTS



STREET WORKOUT

WORKOUT SET
WS026

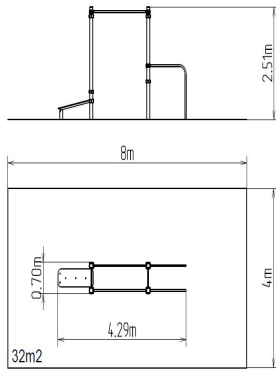
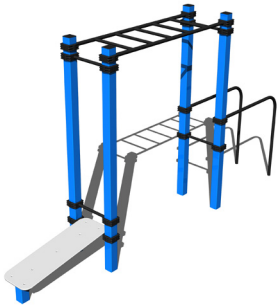

15+



1.5 m

COLOUR VARIANTS



IMPACT ZONE
GRASS

WORKOUT SET
WS027

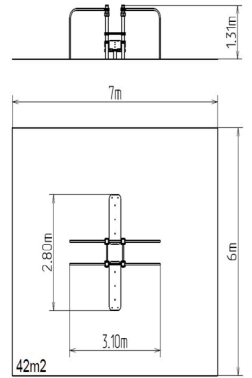
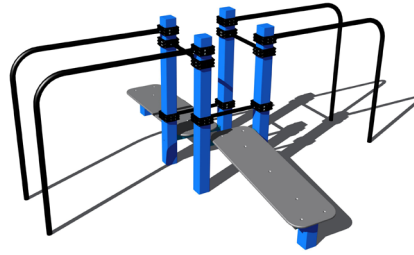

15+



1.5 m

COLOUR VARIANTS



IMPACT ZONE
GRASS

WORKOUT SET
WS025

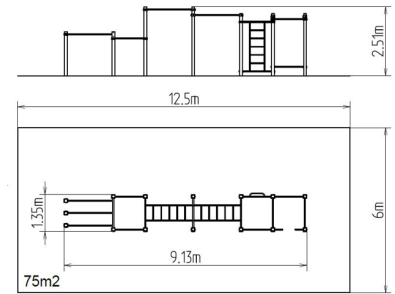
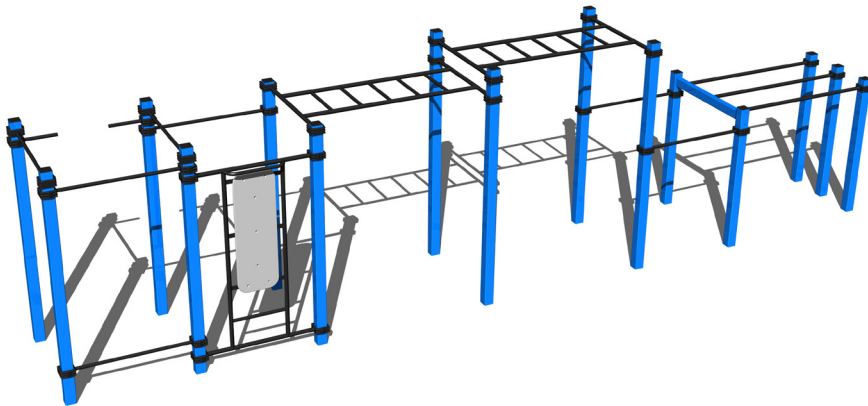

15+



1.5 m

COLOUR VARIANTS



IMPACT ZONE
GRASS

WORKOUT SET
WS030

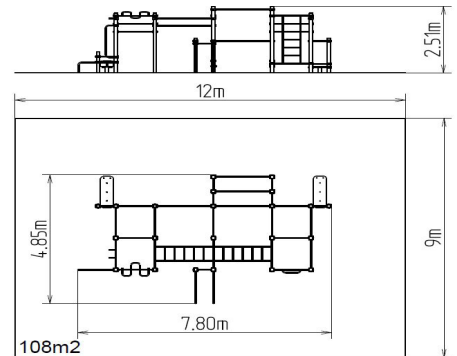
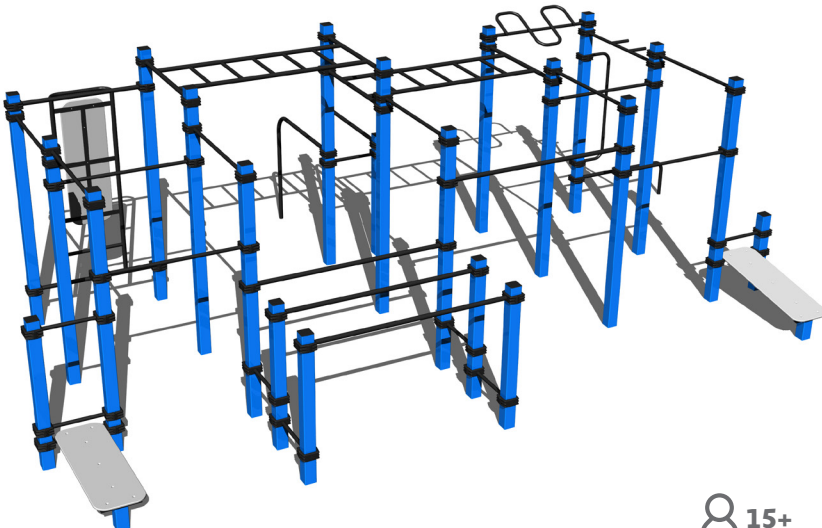

15+



1.5 m

COLOUR VARIANTS



IMPACT ZONE
GRASS

STREET WORKOUT

WORKOUT PARK

WH001

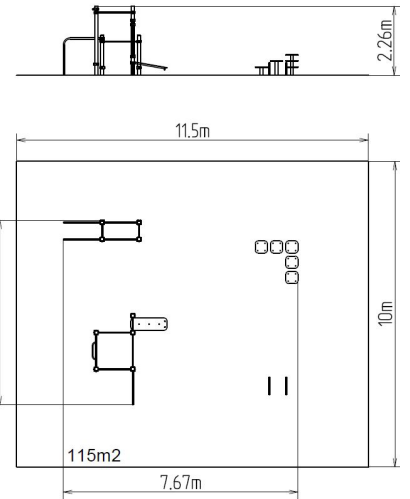
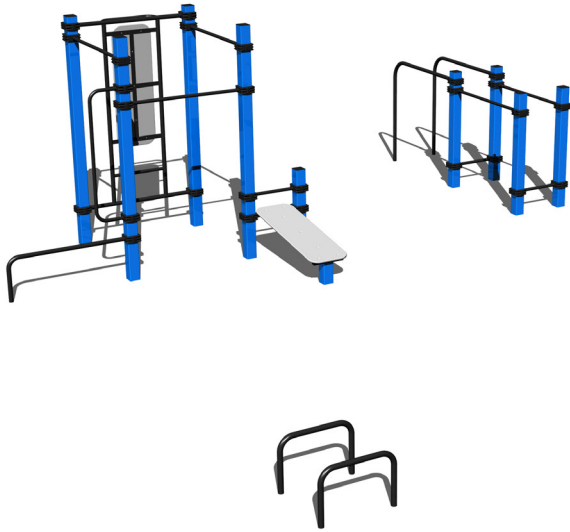

15+ ↓ 1.5 m

COLOUR VARIANTS



WORKOUT PARK

WH002

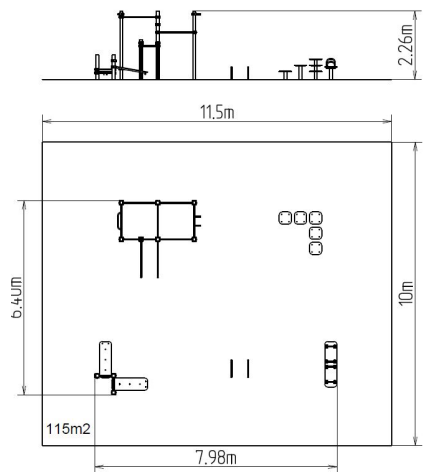
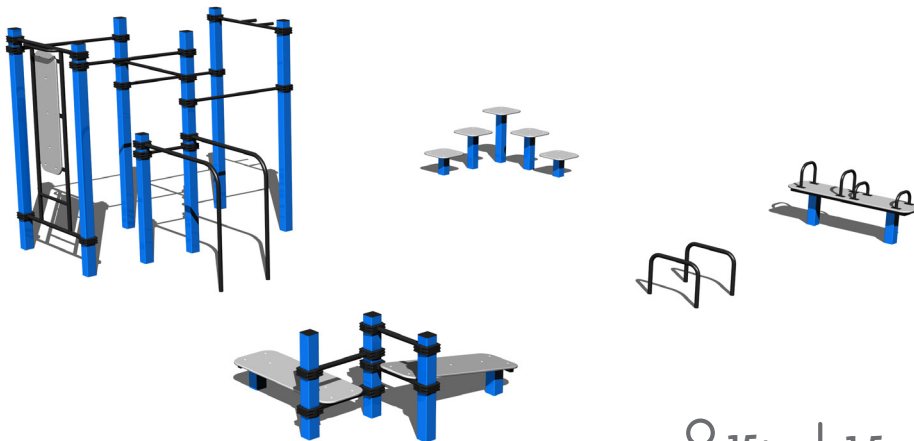

15+ ↓ 1.5 m

COLOUR VARIANTS



INFORMATION BOARD WITH THE RULES OF OPERATION AND WORKOUT PLAN

IW100

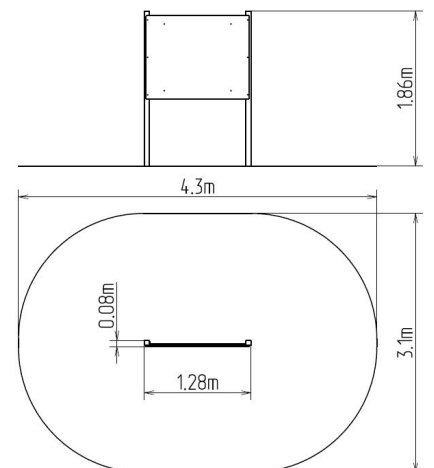



STREET WORKOUT

YOUR STREET YOUR STYLE



Bonita Group Service s.r.o.

Drásov, 664 24 Drásov

CZECH REPUBLIC

info@playgrounds-bonita.com

+420 608 633 163, +420 515 555 100

www.playgrounds-bonita.com