

## Bench LA107D (mobile)

Product type LA-107D-10

### Basic information

|                              |                         |
|------------------------------|-------------------------|
| Age category                 | from 0 years            |
| Minimum area                 | 2,6 m x 1,5 m           |
| Equipment measurements       | 1,6 m x 0,48 m x 0,45 m |
| Free fall height:            | 0,45 m                  |
| Load capacity:               | Not specified           |
| Max. number of users:        | Not specified           |
| Fall zone: EN 1177           | Not specified           |
| Designation:                 | exterior                |
| Availability of spare parts: | supplied by the         |
| Certificate of Compliance:   | ČSN EN 1176 - 1         |

### Material

Metal units - structural steel  
Wooden units - spruce wood or oak

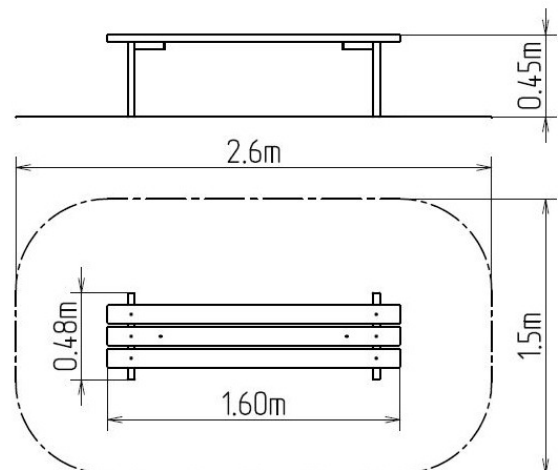

### Finish

Impregnation and coating with a triple layer of lacquer  
Hot-dip galvanizing

### Description

The bench is made from spruce wood, or oak should the client require. The wood is impregnated and coated with a triple layer of lacquer, which meets the terms and conditions of the EN71/3 Standard (safe for children's toys). The posts of the bench are made from structural steel (steel profile of 40 x 40 mm), protected against corrosion by hot-dip galvanizing, which significantly prolongs the life of the play unit. All fastening material is galvanized or stainless steel.