

## Climbing set SS8411KW - brown

Product type SS-8411KW-10

### Basic information

Age category	2 - 10 years
Minimum area	5 m x 4,3 m
Equipment measurements	2 m x 1,3 m x 0,96 m
Free fall height:	1 m
Load capacity:	216 kg
Max. number of users:	4
Fall zone: EN 1177	Grass surface
Designation:	exterior
Availability of spare parts:	supplied by the
Certificate of Compliance:	ČSN EN 1176 - 1

### Material

Metal units - structural steel  
Ropes and nets - polypropylene with a steel internal core  
Plastic units - polyamide

### Finish

Duplex powder coated with coat curing  
Hot-dip galvanizing

### Description

The support structure of the climbing set is made from structural steel, it is zinc coated which significantly prolongs the life of the play unit or duplex powder coated with coat curing according to RAL to prevent corrosion and it is fixed in a concrete bed. All other metallic elements are also zinc coated or duplex powder coated with coat curing according to RAL to prevent corrosion.. The climbing nets and rope ladder are made using HERKULES material (16 mm thick ropes made from polypropylene with a steel internal core) and they are connected with plastic joints. All fastening material is galvanized or stainless steel.

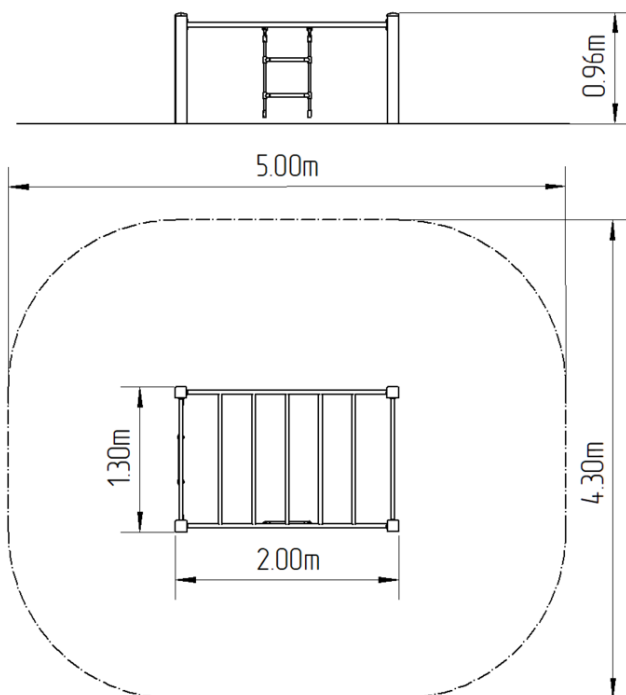

### Equipment

Climbing net, pole climbing, swedish ladder, rope ladder.