

Bench LA117KZnD (mobile)

Product type LA-117KZnD-10

Basic information

Age category	from 0 years
Minimum area	2,6 m x 1,5 m
Equipment measurements	1,6 m x 0,48 m x 0,45 m
Free fall height:	0,45 m
Load capacity:	Not specified
Max. number of users:	Not specified
Fall zone: EN 1177	Not specified
Designation:	exterior
Availability of spare parts:	supplied by the
Certificate of Compliance:	ČSN EN 1176 - 1

Material

Metal units - structural steel
Wooden units - spruce wood or oak

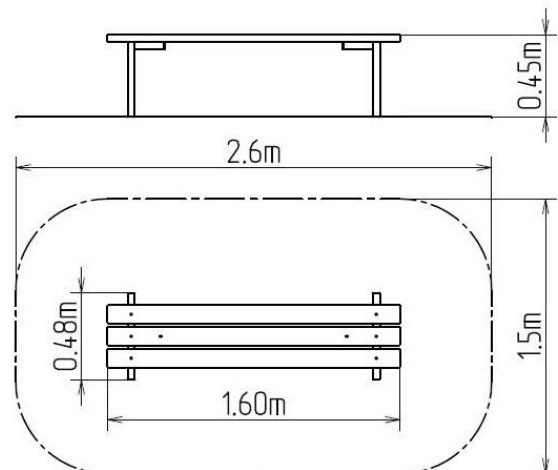

Finish

Impregnation and coating with a triple layer of lacquer
Hot-dip galvanizing

Description

The bench is made from spruce wood, or oak should the client require. The wood is impregnated and coated with a triple layer of lacquer, which meets the terms and conditions of the EN71/3 Standard (safe for children's toys). The posts of the bench are made from structural steel, protected against corrosion by hot-dip galvanizing, which significantly prolongs the life of the play unit. All fastening material is galvanized or stainless steel.