

Chain swing Nest RH170KW-Q - Brown (f.h. 1,5 m) (Coastal

Product type RH-170KW-15-Q

Basic information

| | |
|------------------------------|-------------------------------------|
| Age category | 2 - 15 years |
| Minimum area | 6 m x 7,5 m |
| Equipment measurements | 2,5 m x 1,75 m x 2,24 m |
| Free fall height: | 1,5 m |
| Load capacity: | 270 kg |
| Max. number of users: | 5 |
| Fall zone: EN 1177 | Rubber or gravel, 19 m ² |
| Designation: | exterior |
| Availability of spare parts: | supplied by the |
| Certificate of Compliance: | ČSN EN 1176 - 1, 2 |

Material

Metal units - structural steel
 The "Bird's Nest" seat - polypropylene rope with heavy duty fibres
 The hanging ropes - polypropylene with a steel internal core

Finish

Duplex powder coated with coat curing
 Hot-dip galvanizing

Description

The support structure of the swing is made from structural steel (steel profile 100 x 100 mm), which is zinc coated and KOMAXIT powder coated according to the RAL colour chart and is fixed in a concrete bed.
 The swing is hung on a metal girder using galvanized chains. The "Bird's Nest" seat is made from polypropylene rope with heavy duty fibres. The hanging ropes are made using HERKULES material (16 mm thick ropes made from polypropylene with a steel internal core). All fastening material is galvanized or stainless steel.

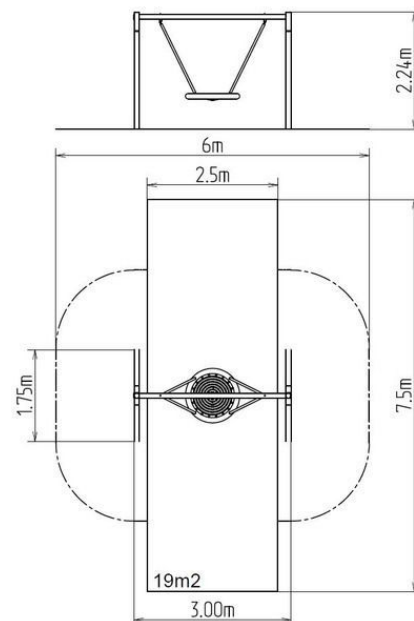

Equipment

We offer three color variants of the support structure - red, blue and brown.